



WCL-B5-6mA&30mA

$I_p=6mA(DC)\&30mA(AC)$



产品特点 Products Features

- 安装方便
Easy mounting
- 体积小, 节省空间
Small size and space saving
- 无插入损耗
No insertion losses
- 抗干扰能力强
High immunity to external interference

应用领域 Applications

- 直流电机驱动静态转换器
Static converters for DC motor drives
- 通讯电源
Battery supplied applications
- 不间断电源 (UPS)
Uninterruptible Power Supplies
- 开关电源 (SMPS)
SWITCHED Mode Power Supplies
- 电焊机
Power supplies for welding applications

机械尺寸 Mechanical dimension

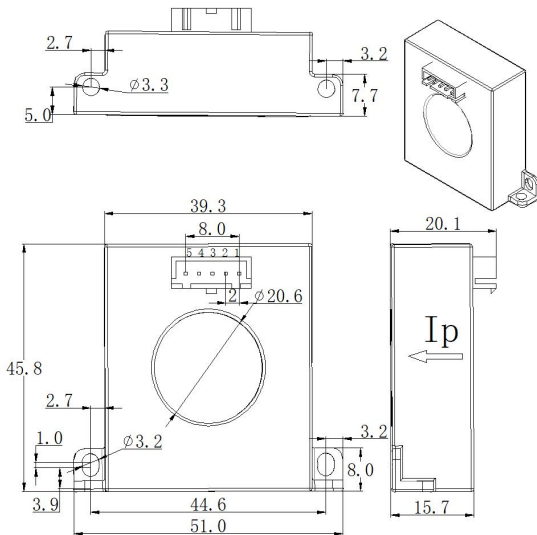

No.	Symbol	Description
1	VCC	Power supply
2	VO	High and low level output
3	GND	Power GND
4	/	NC-Float
5	CHK	Product Self-Check input
Line-A-H	IP	Primary Current

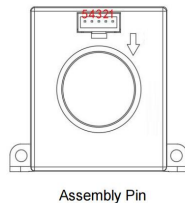

机械特性 Mechanical characteristics

一般公差
General tolerance
 $\pm 0.5\text{ mm}$

其它公差执行
Other tolerance execution
GB/T 1804-2000-M

固定孔尺寸
Fixing hole size
 $\Phi 3.3\text{mm}$

紧固螺丝
Fastening steel screw
M3

建议紧固扭矩
Recommended fastening torque
1.0Nm ($\pm 10\%$)

连接器
Connection of secondary
PHB-5A (2.0mm)

注意 Remarks

错误的接线可能导致传感器损坏。

The false wiring may result in the damage of the sensor.

I_p 方向与产品箭头方向一致时, 输出电压为正极。

V_{OUT} is positive when I_p flows in the direction of the arrow.

当初级导体完全充满初级孔径时动态表现 (di/dt 和响应时间) 为最佳效果。

Dynamic performances (di/dt and response time) are best with a single bar completely filling the primary hole.

初级导体的温度不应超过 100°C 。

Temperature of the primary conductor should not exceed 100°C .

电气参数Electrical data WCL-B5-6mA

除非另有说明，否则环境参数均为@ $T_A = 25^\circ\text{C}$,

型号 Type	WCL-B5-6mA&30mA
额定测量电流 I_P Rated input	$\pm 6\text{mA (DC) \& 30mA (AC)}$
测量范围 I_{PM} Measure range	$\pm 500\text{mA}$
自检输出电压 $V_{(ck)}$ Output voltage (Check function)	V_{CC}
自检电流 I_{ck} Self-Check current	30mA
动态输出电压 $V_{(CE)}$ Check enable voltage	$0.7V_{CC} \sim V_{CC}$
静态输出电压 $V_{(CD)}$ Check disabled voltage	$\leq 0.2\text{V}$
静态电流消耗 I_c Current consumption	$\leq 30\text{mA} (@+5\text{V}, I_p=0)$
电源电压 V_c Supply voltage	$+4.9 \sim 5.3\text{VDC} (\pm 5\%)$
频带宽度 BW Frequency bandwidth-3db	DC or 50Hz
上电时间 T_{on} Power on initialization time	60ms
工作环境温度 T_A Ambient operating temperature	$-40 \sim +85^\circ\text{C}$
储存环境温度 T_s Ambient storage temperature	$-40 \sim +105^\circ\text{C}$
绝缘耐压 V_D Galvanic isolation	50Hz, 1min, 3KV
质量 m Mass	$\approx 25\text{g}$
执行标准 Standards	JB/T 7490-2007

自检时序图Self-check Timing Diagram

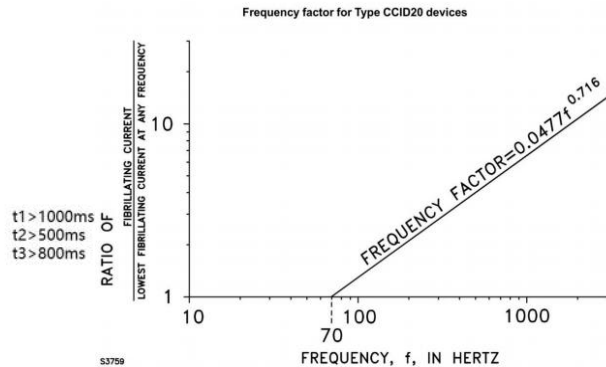
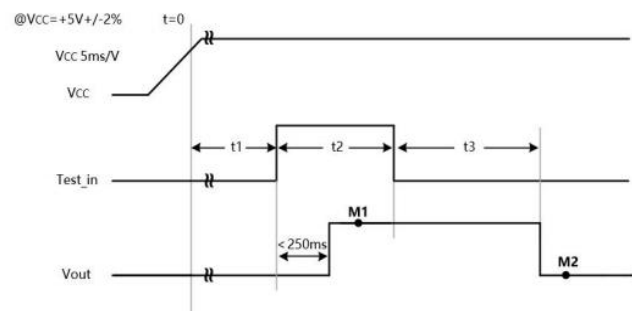

定制Customized

这是一个标准的产品，需要其他规格（测量电流、电源电压、输出电压、连接器、转换比率等）请联系我们。
This is a standard model. For different versions (I_P , supply voltages, output voltages, connection of secondary, turns ratios...), please contact us.

联系方式Contact information

李伟军 18576721398 www.gchsensor.com victor801@vicorv.com